

83314-2 Series Latch SR83314 Kick-out Spring

*Up Lever Easier
To Grasp*

83314-42 Series Latch:

Strong, dependable with three
compression springs.
Up lever.

- Dimensions shown are as mounted.
- Ship wt./100: 12 lb.

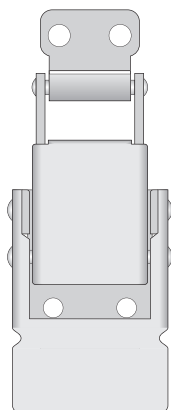

HC83314 Latch
HS83314 Strike

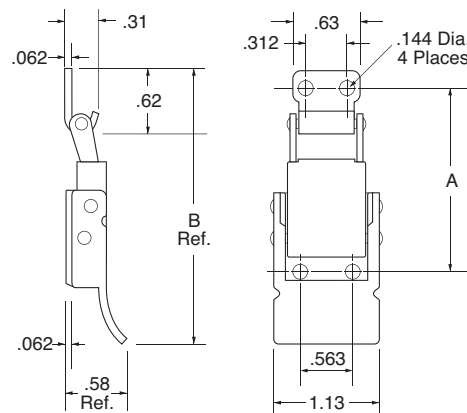

Dimensions

Desired Tension	A	B
30 lbs.	1.813	2.79
50 lbs.	1.875	2.85
70 lbs.	1.938	2.91

Part Number

Latch	Strike	Finish	Material
HC83314-42SS	HS83314SS	None	Stainless Steel
HC83314-42ZE	HS83314ZE	Zinc	Steel

*Holds Latch Away from Strike
for Easy Cover Removal*

SR83314 Kick-Out Spring:

Swings latch away from strike when
latch is released. Used in
applications when latch is
cover-mounted.

- Dimensions shown are as mounted.
- Ship wt./100: 12 lb.

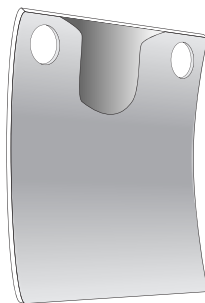

SR83314

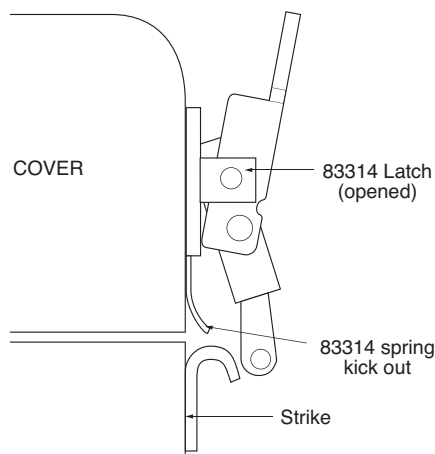

Part Number

Latch	Finish	Material
SR83314-1SS	None	Stainless Steel